

**WATER POLLUTION ABATEMENT PLAN APPLICATION**  
**FOR CONSTRUCTION OF**  
**ONE SINGLE-FAMILY RESIDENCE**  
**or**  
**TWO CONTIGUOUS SINGLE-FAMILY RESIDENCES**  
**ON THE EDWARDS AQUIFER RECHARGE ZONE**  
**AND RELATING TO 31 TAC §313.4 EFFECTIVE MARCH 21, 1990**

EDWARDS AQUIFER, Comal County

PROJECT NAME: James & Denise Hunt-Residence

TYPE: Water Pollution Abatement Plan (WPAP), 30 Texas  
Administrative Code (TAC) 313.4

Do not write in this box. TNRCC use only.	
Received by Region (Day 1)	
Fee Due:	\$
Payment Verified	
Inspection Date:	
Judged administratively ____ complete ____ incomplete (Day 60)	
Written Comments Received From City/County: UWCD within 30 Days:	____ Yes ____ No ____ Yes ____ No
____ Approved (Day 150) ____ Incomplete & Returned	

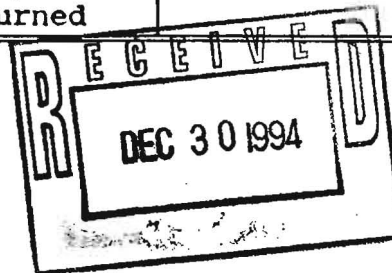

If form is not on computer disk  
attach answers directly behind this page.

2/1/94

Page 1

As owner of the property listed below I am requesting an exception to the application fee requirements of a water pollution abatement plan for one single-family residence (or two contiguous single-family residences) located on the Recharge Zone of the Edwards Aquifer at:

Address: 1001 RIAPA DRIVE & \_\_\_\_\_  
NEW BRAUNFELS, Texas TX & \_\_\_\_\_, Texas \_\_\_\_\_

The exception to the application fee is based on the acreages listed in the table below.

Edwards Aquifer Protection Program Suggested WPAP Fee Exceptions for One Single Family Residence on 5 Acres or Less						
Type	Acres					
	1 <sup>2</sup>	≤2	≤3	≤4	≤5	> 5.0
One (1) Single-Family Residence <sup>1</sup>	*\$300	*\$350	*\$400	*\$450	*\$500	Not Regulated.  No Application Fee.
*Note - This reduced fee requires an exception request and approval. 1 - More than 1 house constitutes residential subdivision. 2 - Minimum lot size serviced by on-site sewage treatment is one (1) acre.						

All fees must be submitted to the TNRCC at the address listed below and a copy of the receipt from TNRCC's Fiscal Services Section is attached.

TNRCC - CASHIER  
 FINANCIAL ADMINISTRATION SECTION 12100 PARK 35 CIRCLE  
 P.O. BOX 13088 BUILDING A, 3rd FLOOR  
 AUSTIN, TEXAS 78711-3088 AUSTIN, TEXAS 78758

	Lot #1	Lot #2	Total
Acreage			
Fee due			

James D. Hunt  
 Signature

JAMES D. HUNT  
 Printed Name

12-29-94  
 Date

If form is not on computer disk  
 attach answers directly behind this page.

2/1/94  
 Page 11

Please list any comments or suggestions you may have to improve this application. They will be considered for inclusion in the next edition of this form.

If form is not on computer disk  
attach answers directly behind this page.

2/1/94  
Page 12

**TEXAS NATURAL RESOURCE CONSERVATION COMMISSION**  
**WATER POLLUTION ABATEMENT PLAN**  
**GENERAL CONSTRUCTION NOTES**

1. This Regulated Development shall meet all applicable criteria of the Texas Natural Resource Conservation Commission criteria set forth in 30 Texas Administrative Code (TAC) §313.4 - Water Pollution Abatement Plan for Regulated Development located on the Recharge Zone of the Edwards Aquifer.
2. During construction, the storm water runoff from all disturbed areas shall be filtered by silt fences and rock berms. These temporary erosion and sedimentation controls shall remain in place until the disturbed areas are revegetated and the areas have become permanently stabilized. All temporary erosion and sedimentation controls shall be inspected periodically for damage caused by construction activities and following every rainfall. Damaged or obstructed controls shall be repaired/replaced as necessary to maintain their proper operation.
3. If any significant recharge features are discovered during construction, all construction activity near the significant recharge feature will be immediately suspended. The appropriate Regional Office of the Texas Natural Resource Conservation Commission shall be notified and no activities resumed until a plan to protect the aquifer from any potential adverse impacts has been submitted, reviewed, and approved.
4. Any modifications to the approved plans for this regulated development must be submitted for approval by the Executive Director of the Texas Natural Resource Conservation Commission before construction of the proposed modification may commence.
5. All contractors conducting regulated activities associated with this proposed regulated project shall be provided with copies of the Water Pollution Abatement Plan submittal and the TNRCC letter indicating the specific conditions of its approval. During the course of these regulated activities, the contractors shall be required to keep on-site copies of the submittal and the approval letter.



# EDWARDS AQUIFER TECHNICAL GUIDANCE MANUAL

30 TAC Section 313.27  
 Edwards Aquifer Protection Program  
 Suggested WPAP Fee Exceptions for  
 Each Single-Family Residence on 5 Acres or Less  
 &  
 Standard Application Fee Schedule

Type	Acres					
	1 <sup>2</sup>	≤2	≤3	≤4	≤5	>5.0
One Single Family Residence <sup>1</sup>	*\$300	*\$350	*\$400	*\$450	*\$500	Not Regulated  No Application Fee

Standard WPAP Application Fees

- Residential Subdivision	\$1,000	\$2,000	\$2,000	\$2,000	\$2,000	\$2,000
- Commercial						
- Industrial						
- Churches						
- Schools						
- Parks						
- Roadways						
- Other						

Modification and Amendments - Same As Application Fee.

Note - This Reduced Fee Requires an Exception Request and Approval

1 - More than 1 house constitutes a residential subdivision

2 - Minimum lot size serviced by on-site sewage treatment is one (1) acre.

All fees must be submitted to the TNRCC at the following address:

Texas Natural Resource Conservation Commission  
 Fiscal Services Section  
 P.O. Box 13087  
 Austin, Texas 78711-3087

Do not write in shaded areas. For use only.

SB NA

SB = Submitted NA = Not Applicable

After 1/1/95 contact the appropriate regional office of the Texas Natural Resource Conservation Commission to obtain the latest version of this APPLICATION for TWO OR LESS SINGLE-FAMILY RESIDENCES.

1. Enter Site Address (if assigned), County, City:

Street (If assigned) 1001 RIADA Drive  
City, State, Zip New Braunfels, TX. 78132

\_\_\_ This project is inside the city limits of the City of \_\_\_\_\_.

\_\_\_ This project is outside the city limits but inside the City of \_\_\_\_\_ ETJ (extra-territorial jurisdiction).

✓ This project is outside the city limits, outside the city's ETJ but in Comal County.

2. The location of the project site is described below (Example: "NE corner of Bitters & Heimer Roads", "On east side of Heimer Road, 1/4 mile north of Bitters Road").

West of IH 35; 3 miles on FM 206,  
Left to Bretzke Lane to RIADA subdivision,  
1/4 mile down RIADA Drive Left to 11A

3. Applicant:

Contact Person:  
Entity:  
Mailing Address  
City, State:  
Zip:  
Telephone:

Doug Hunt  
Doug Hunt  
1001 RIADA Drive  
New Braunfels, TX.  
78132  
(210) 609-0902

If form is not on computer disk  
attach answers directly behind this page.

2/1/94  
Page 2

- ☐ ☐ 4. Check the name of the Underground Water Conservation District in the area (if one exists).

☒ Barton Springs/Edwards Aquifer  
☒ Edwards Underground  
☐ Medina County  
☐ Uvalde County  
☐ Site is not within an UWCD

- ☐ ☐ 5. ☒ A Road Map is attached behind this sheet showing the location of project site and route/mileage from an existing known site or intersection.

- ☐ ☐ 6. ☐ A copy of the official 7½ minute USGS quadrangle map(s) of the Edwards Recharge Zone is attached behind this sheet. Maps are available from:

Accugraphics 512/459-4929

Barton Springs/Edwards Aquifer District 512/282-8441

Edwards Underground Water District 210/222-2204

Ferguson Map Company 210/341-6277

The map(s) should clearly show:

1. Project site.
2. USGS Quadrangle Name(s),
3. Boundaries of the Recharge Zone (and Transition Zone, if applicable),
4. Drainage path from the project to the boundary of the Recharge Zone.

- ☐ ☐ 7. Is your house located within an existing subdivision?

☒ Yes, Name of Subdivision: RIADA

☐ Does the existing subdivision have approval pursuant to 30 TAC §313.4 for a water pollution abatement plan?

☐ YES, a copy of the approval letter is attached.

☒ NO

☐ No, the proposed house will not be located within an existing subdivision.

- ☐ ☐ 8A. ☐ This application is for the construction of 1 single-family residence(s).

If form is not on computer disk  
attach answers directly behind this page.

2/1/94

Page 3

CITY OF  
NEW BRAWNFELS

11A

$\frac{1}{4}$  TO LET 11A  
ON LEFT SIDE

GATE # 6164

35 NORTH

BRETZKE LAKE  $\frac{1}{4}$  MILE

TO GATE

2.5 MILES

306

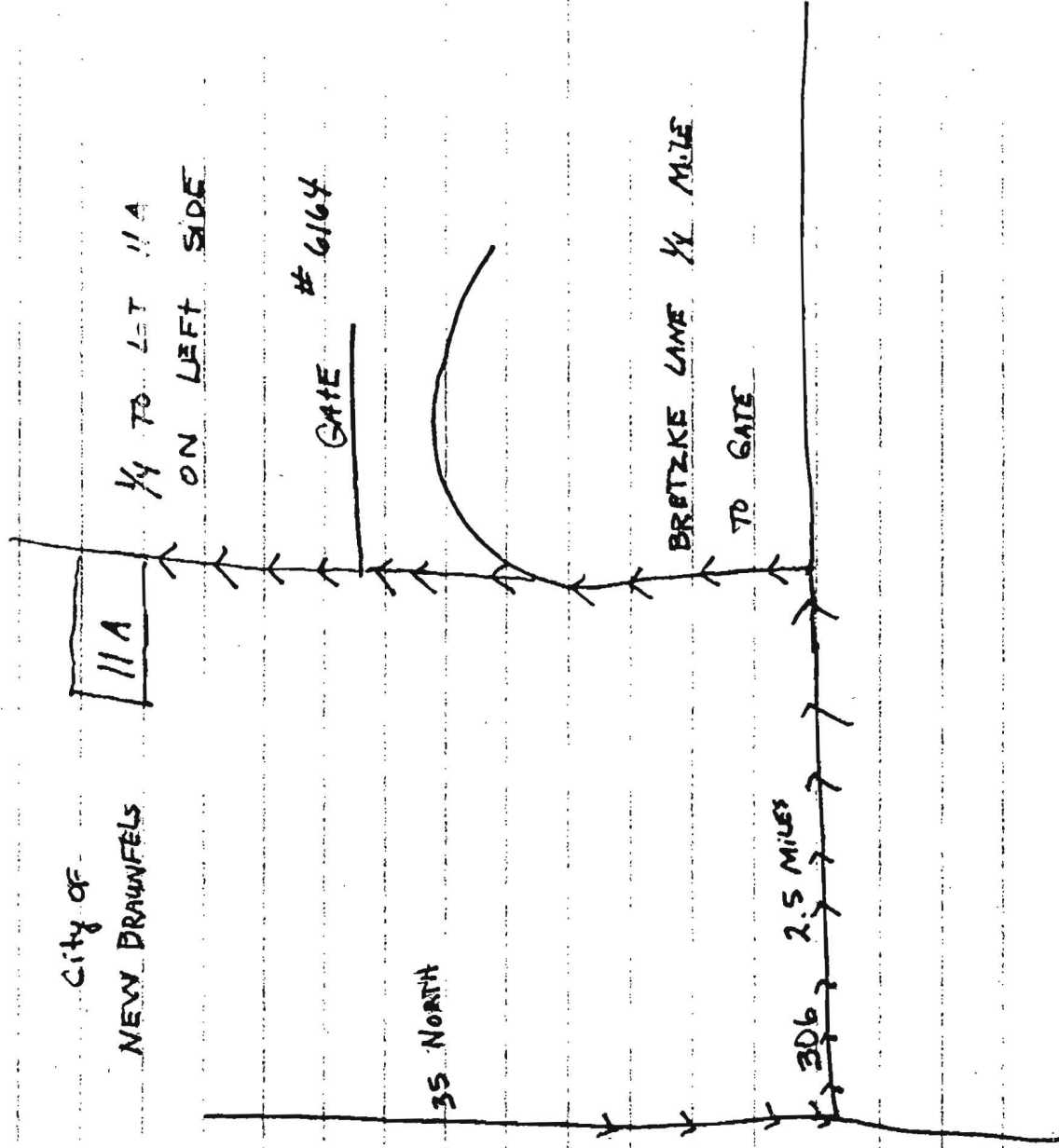



☐ 8B. Size of Lot #1: 3 acres  
 Size of Lot #2: \_\_\_\_\_  
 Total acres: 3 acres

☐ 8C. Fee Due:.....\$ 400.<sup>00</sup>

☐ 8D. Projected population:.....3

☐ 8E. Source of potable water is:  
 \_\_\_\_\_ City of Austin  
 \_\_\_\_\_ City of Georgetown  
 \_\_\_\_\_ City of Round Rock  
 \_\_\_\_\_ City of San Marcos  
 \_\_\_\_\_ New Braunfels Utilities  
☒ Private on-site water well(s)  
 \_\_\_\_\_ San Antonio Water System  
 \_\_\_\_\_ Water purveyor: \_\_\_\_\_  
 \_\_\_\_\_ Other: \_\_\_\_\_

9.	Impervious Cover of Proposed Project	Sq. Ft.	Sq. Ft./Acre	Acres
<input type="checkbox"/>	Structures/Rooftops	<u>Ap. 5,500</u>	+ 43,560 =	<u>.13</u>
<input type="checkbox"/>	Parking/Paved Surfaces	<u>Ap. 6,000</u>	+ 43,560 =	<u>.14</u>
<input type="checkbox"/>	Other: _____		+ 43,560 =	
<input type="checkbox"/>	Total:	<u>11,500</u>	+ 43,560 =	<u>.27</u>
<input type="checkbox"/>	("Total Impervious Cover") ÷ ("Total Acreage") x 100 = % Impervious Cover =			<u>.27</u> %

☐ 10A. The existing conditions on project site are noted below.

The project site is:  
 \_\_\_\_\_ Existing commercial site  
 \_\_\_\_\_ Existing industrial site  
 \_\_\_\_\_ Existing residential site  
 \_\_\_\_\_ Existing paved &/or unpaved roads  
☒ Undeveloped (Cleared)  
 \_\_\_\_\_ Undeveloped (With woods & meadows)  
 \_\_\_\_\_ Other: \_\_\_\_\_

☐ 10B. Municipal solid waste, and/or hazardous waste:

☐ There are areas of trash, debris or other municipal solid waste or hazardous waste on this property which will be disposed of properly at an authorized landfill prior to commencing construction. Other (Described on following page under "ITEM #10B"):

☒ There are no areas of trash, debris or other municipal solid waste or hazardous waste existing on this property.

☐ Other waste (Described on following page under "ITEM #10B"):

☐ 11. Wastewater to be generated by proposed project [30 TAC §313.4(b)(A)(11)].

Wastewater to be generated by proposed project:	
Character	Volume
<u>100</u> % Domestic	<u>Ap. 500</u> gallons/day
% Industrial	gallons/day
TOTAL	<u>Ap. 500</u> gallons/day

12. The Method of Wastewater Disposal is:

☐ 12A. ☒ On-Site Sewage Treatment (Septic Tank):

On-site septic tanks will be used to treat and dispose of wastewater. The appropriate licensing authority's letter is attached directly behind this page. It states that the land is suitable for the use of a septic tank or identifies areas that are not suitable.

Furthermore, I am aware that the minimum lot size for a septic tank on the Recharge Zone is one (1) acre. Each lot in this project/development is at least one (1) acre in size and the on-site treatment facility will be designed and installed by a licensed sanitarian or engineer.

If form is not on computer disk  
attach answers directly behind this page.

2/1/94

Page 5

☐ 12B. On-site Sewage Collection System (Sewer Lines):

— This project will connect to an existing sewage collection system with a private service lateral line to convey wastewater from each residence off the Recharge Zone for treatment and disposal at the EXISTING / PROPOSED (circle one) \_\_\_\_\_

\_\_\_\_\_ Sewage Treatment Plant (S.T.P.).  
All private service laterals will be inspected as required in 30 TAC 313.5(c)(9) by:

Entity Name: \_\_\_\_\_  
Address: \_\_\_\_\_  
City, State, Zip: \_\_\_\_\_  
Telephone: \_\_\_\_\_

— A proposed organized sewage collection system (SCS) will convey wastewater from these residences to an existing wastewater line for conveyance off the Recharge Zone for treatment and disposal at the EXISTING / PROPOSED (circle one) \_\_\_\_\_

\_\_\_\_\_ Sewage Treatment Plant (S.T.P.).  
Furthermore, I am aware that an on-site sewage collection system application is required by 30 TAC 313.5 and must be submitted to the TNRCC for review and approval consideration. All private service laterals will be inspected as required in 30 TAC 313.5(c)(9) by:

Entity Name: \_\_\_\_\_  
Address: \_\_\_\_\_  
City, State, Zip: \_\_\_\_\_  
Telephone: \_\_\_\_\_

☐ 13. A Site Plan is required. It shall have a minimum scale of 1" = 400'.

Site Plan Scale: 1" = 50' feet.

☐ 14. The Site Plan shall include the following:

☐ 14A. 100-year floodplain's boundaries which are within the site and 200 feet downgradient.

\* — The attached letter from the COMAL County floodplain coordinator states that no part of this project is located within the 100-year floodplain.

If form is not on computer disk  
attach answers directly behind this page.

2/1/94

Page 6

\_\_\_\_\_ The attached letter from the \_\_\_\_\_ County floodplain coordinator states that ~~some~~ part(s) of this project is located within the 100-year floodplain, and it is labeled on the site plan.

\_\_\_\_\_ The attached letter from \_\_\_\_\_ Engineering Company states that a site specific engineering study, performed by them in \_\_\_\_\_ (year), determined that no part of this project is located within the 100-year floodplain and it is labeled on the site plan.

\_\_\_\_\_ The attached letter from \_\_\_\_\_ Engineering Company states that a site specific engineering study, performed by them in \_\_\_\_\_ (year), determined that ~~some~~ part(s) of this project is located within the 100-year floodplain and it is labeled on the site plan.

☒ 14B. \_\_\_\_\_ Layout of the development (Location of lots, buildings, roads, etc.) is shown on the site plan.

☒ 14C. \_\_\_\_\_ Existing topographic contours are shown on the site plan. The contour interval is \_\_\_\_\_ feet (are not greater than 5 feet). The contour lines are clearly labeled on the site plan.

☒ 14D. \_\_\_\_\_ The locations of all known wells (oil, water, unplugged, capped and/or abandoned, test holes, etc.).

✓ \_\_\_\_\_ There are no wells or test holes of any kind known to exist on this project site.

\_\_\_\_\_ (#) wells are present on the project site and their locations are labeled on the Site Plan.

\_\_\_\_\_ The wells are not in use and have been properly abandoned.

\_\_\_\_\_ The wells are not in use and will be properly abandoned.

\_\_\_\_\_ The wells are in use and comply with 30 TAC §287.50(a).

☒ 14E. \_\_\_\_\_ Temporary stockpile areas (soil, sand, gravel, excavated material, etc.):

If form is not on computer disk  
attach answers directly behind this page.

2/1/94  
Page 7



— Temporary stockpile areas are shown on the site plan. Appropriate erosion & sedimentation controls are labeled.

✓ — There are no stockpile areas anticipated for this project. However, any unanticipated temporary stockpile areas shall have erosion and sedimentation controls placed appropriately.

— Spoil materials will be disposed of on the Recharge Zone at the site identified on following page under "ITEM #14F".

— All spoil materials will be disposed of off the Recharge Zone at the site identified on following page under "ITEM #14F".

■ ■ 14F. Point(s) of exit from construction site.

— A Stabilized Construction Exit (SCE) shall be provided at each exit labeled on the Site Plan Sheet. A design for the entrance is shown on the Site Plan Sheet.

■ ■ 14G. Recharge features (caves, sinkholes, fractured rock, etc.) which are located within the development or within 200 feet downgradient of the site.

— An inspection of the project site did reveal potential recharge features which are labeled on the site plan.

✓ — An inspection of the project site did not reveal potential recharge features on the site plan.

#### 15. Other Activities:

■ ■ 15A. Will there be any temporary hydrocarbons or hazardous substance storage associated with this project?

— Yes, and I am aware that a separate application for Aboveground or Underground hydrocarbon or hazardous substance storage must be submitted pursuant to 30 TAC §313.10/313.11.

✓ — No

■ ■ 15B. Will there be any permanent hydrocarbons or hazardous substance storage associated with this project?

If form is not on computer disk  
attach answers directly behind this page.

2/1/94

Page 8



☐ Yes, and I am aware that a separate application for Aboveground or Underground hydrocarbon or hazardous substance storage must be submitted pursuant to 30 TAC §313.10/313.11.

☒ No, there will be no permanent hydrocarbons or hazardous substance storage on this project site.

☐ 15C. Will there be any sewage holding tanks or cesspools? (Do not include septic tanks.)

☐ Yes  
☒ No

☐ 15D. A feedlot/concentrated animal feeding operation is defined in 30 TAC §321.32 to be "A concentrated, confined livestock or poultry facility operated for meat, milk, or egg production, growing, stabling, or housing, in pens or houses wherein livestock or poultry are fed at the place of confinement and crop or forage growth or production of feed is not sustained in the area of confinement."

Will there be any new feedlot/concentrated animal feeding operations associated with this project?

☐ Yes  
☒ No

☐ 15E. Will there be any waste disposal wells regulated under 30 TAC §331 of this title relating to Underground Injection Control?

☐ Yes  
☒ No

☐ 15F. Will there be any land disposal of Class I wastes, as defined in 30 TAC §335.1?

☐ Yes  
☒ No

☐ 15G. Will there be any land disposal of Municipal Solid Waste as defined in 30 TAC §330?

☐ Yes  
☒ No

If form is not on computer disk  
attach answers directly behind this page.

2/1/94  
Page 9

- ☐ 16. ☒ This form, with original signatures, and three (3) copies of this completed application shall be submitted to the appropriate Regional Office for distribution by the TNRCC to the local municipality or county, underground water conservation district, and the TNRCC's Central Office.
- ☐ 17. ☒ The proposed project is located in Bexar, Comal, Kinney, Medina, or Uvalde County and is being submitted to the **SAN ANTONIO** Regional Office.
- ☐ The proposed project is located in Hays, Travis or Williamson County and is being submitted to the **AUSTIN** Regional Office.
- ☐ 18. ☒ Pursuant to 30 TAC 313.25, application fees are due and payable at the time the application is filed. The fee has been sent to the commission's Austin headquarters, accompanied by an Edwards Aquifer Fee Application Form. I understand that if the correct fee is not submitted the TNRCC is not required to consider the application until the correct fee is submitted.
- ☐ 19. The blank spaces I have marked above signify that the information required is hereby provided and that, to the best of my knowledge, it accurately reflects the proposed project. This WPAP application was prepared by:

JAMES D. HUNT  
(Print Name of Applicant/Owner/Agent, etc.)

*James D. Hunt*  
(Signature of Applicant/Owner/Agent, etc.)

12-27-94  
(Date)

If form is not on computer disk  
attach answers directly behind this page.

2/1/94  
Page 10